

£600PCM

Southburn terrace, Houghton Le Spring, ,
DH4 7AW



Features

- Two bedroom Flat
- Unfurnished
- Available NOW
- New carpets
- Recently Redecorated

This two-bedroom upper-floor flat at South Burn Terrace offers practical and comfortable living space. The flat is accessed via an entrance hallway, which leads to the stairs that take you up to the main living area.

At the top of the stairs, you'll find a lounge, a good-sized space for relaxing or entertaining. The flat includes a kitchen with enough room for essential appliances and meal preparation.

There is one double bedroom, offering enough space for a bed and storage, along with a single bedroom that could be used as a home office, guest room, or additional storage space.

The bathroom is a spacious room with a bath, over bath shower, sink and toilet.

Rooms to let NE Ltd

Portland House, Belmont Business Pk , DH1 1TW
07841472951
rooms@roomstoletne.co.uk



FLOORPLAN

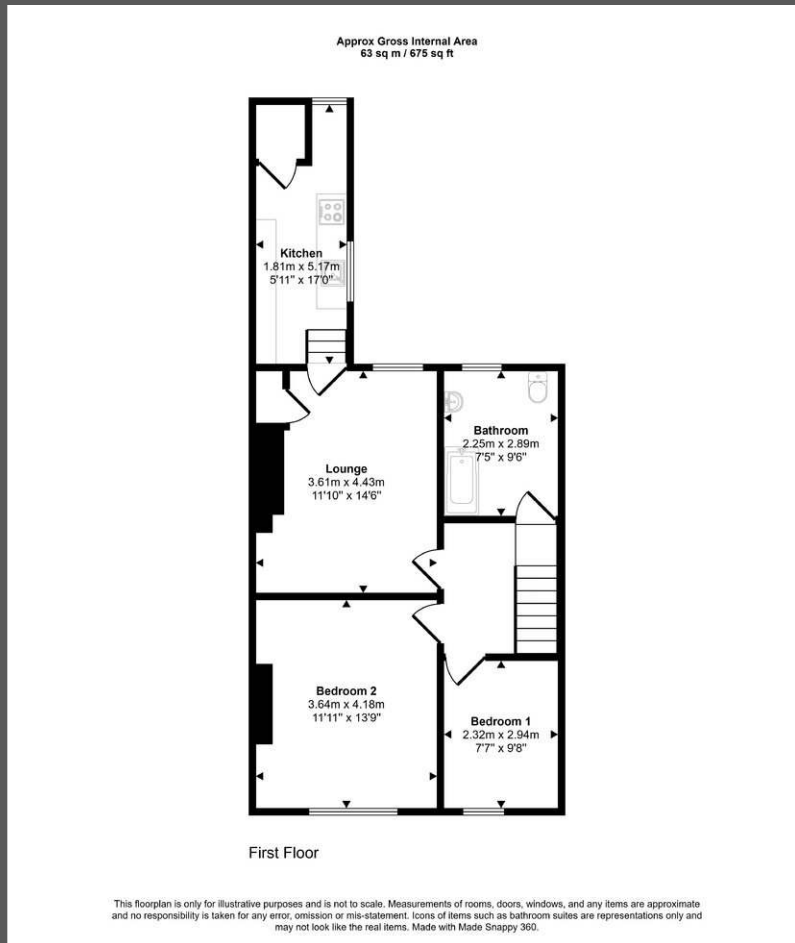

EPCs

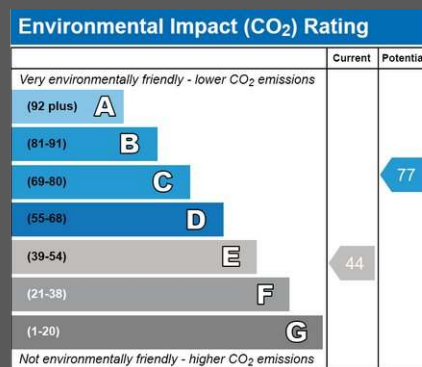
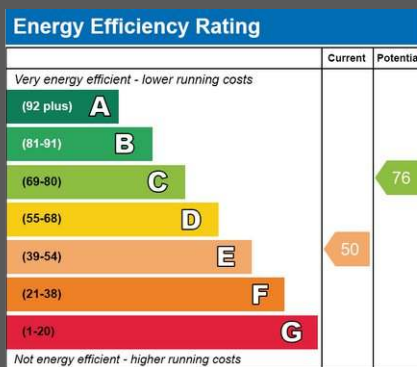

Rooms to let NE Ltd

Portland House, Belmont Business Pk, DH1 1TW
 07841472951
rooms@roomstoletne.co.uk

